



---

<b>REPORT TO:</b>	<b>Area No 2 Development Control Committee</b>
<b>DATE:</b>	<b>3 August 2004</b>
<b>REPORTING OFFICER:</b>	<b>Director of Technical Services (Mrs L Drake – Senior Planner)</b>
<b>SUBJECT:</b>	<b>Tree Preservation Order 19 / 2004</b>
<b>WARDS AFFECTED:</b>	<b>Marston Moor</b>
<b>FORWARD PLAN REF:</b>	

---

### **1.0 PURPOSE OF REPORT**

- 1.1 To request the confirmation of a provisional Tree Preservation Order.

### **2.0 RECOMMENDATIONS**

- 2.1 That (1) the Committee find it expedient in the interests of amenity to confirm the Tree Preservation Order at East of East House, Marston Road, Tockwith.
- 2.2 (2) The Director of Administration be authorised to take appropriate action to secure confirmation.
- 2.3 (3) The order be confirmed as The Council of the Borough of Harrogate Tree Preservation Order No. 19 / 2004.

### **3.0 THE REPORT**

- 3.1 A planning application was submitted on 6<sup>th</sup> May 2004 for the erection of a terrace of four dwellings on land to the east of East House Farm, Marston Road, Tockwith. The application has not yet been determined. The proposed dwellings directly threaten trees on the site and the Council's Arboricultural Officer was consulted. He comments are as follows:

"In the garden of East House there is a particularly fine example of a weeping ash which would be in direct conflict with this proposal. Due to the habit of this

tree, it would be difficult to prune (pruning back laterals on a weeping ash would damage its shape and form while crown lifting defeats the object of having a weeping habit). The unit closest to East House should be removed from the application; in this way it will not conflict with the canopy or root zone of the weeping ash.

iii) In line with the front of the proposed building is a common ash which is worthy of retention. This young tree is well formed, healthy and should be retained. The depth of this site is such that it would be possible to move the proposed building further into the site thus allowing for the retention of the common ash.

Both of the ash trees noted above should be protected by a TPO”

A provision Tree Preservation Order was served on 28<sup>th</sup> May 2004.

- 3.2 One letter has been received from the Parish Council expressing strong support for the TPO.
- 3.3 It is considered that these trees have high amenity value and make a positive contribution to the character and appearance of the conservation area.

#### 4.0 CONCLUSION

- 4.1 The trees, which are the subject of this order, are felt to be of considerable amenity value and an Order is considered appropriate to ensure their retention.

#### Background Papers

None

**OFFICER CONTACT:** Please contact Mrs L Drake, Planning Officer, if you require any further information on the contents of this report. The officer can be contacted at Department of Technical Services by telephone on 01423 556561 or by e-mail

#### SUSTAINABILITY ASSESSMENT/POLICY CONSIDERATIONS

		Implications are		
		Positive	Neutral	Negative
A	Economy			
B	Environment			

C i) ii) iii)	Social Equity General Customer Care/People with Disabilities Health Implications			
D	Crime and Disorder Implications			

If all comments lie within the shaded areas, the proposal is sustainable.

TPSCHEDL 04/00019/TPORDR

27 May 2004

**TREE PRESERVATION ORDER**

**TPO NO 19 / 2004**

**East Of East House, Marston Road, Tockwith Harrogate District North Yorkshire**

**FIRST SCHEDULE**

**TREES SPECIFIED INDIVIDUALLY**

(encircled in black on the map)

Ref on Map	Description	Situation
T1	Weeping Ash	447106 452320
T2	Ash	447117 452319

**GROUPS OF TREES**

(within a broken black line on the map)

Ref on Map	Description (including number of trees)	Situation
None		

**WOODLANDS**

(within a continuous black line on the map)

Ref on Map	Description	Situation
None		

**TREES SPECIFIED BY REFERENCE TO AN AREA**

(within a dotted black line on the map)

Ref on Map	Description	Situation
None		

*S. Pookin*



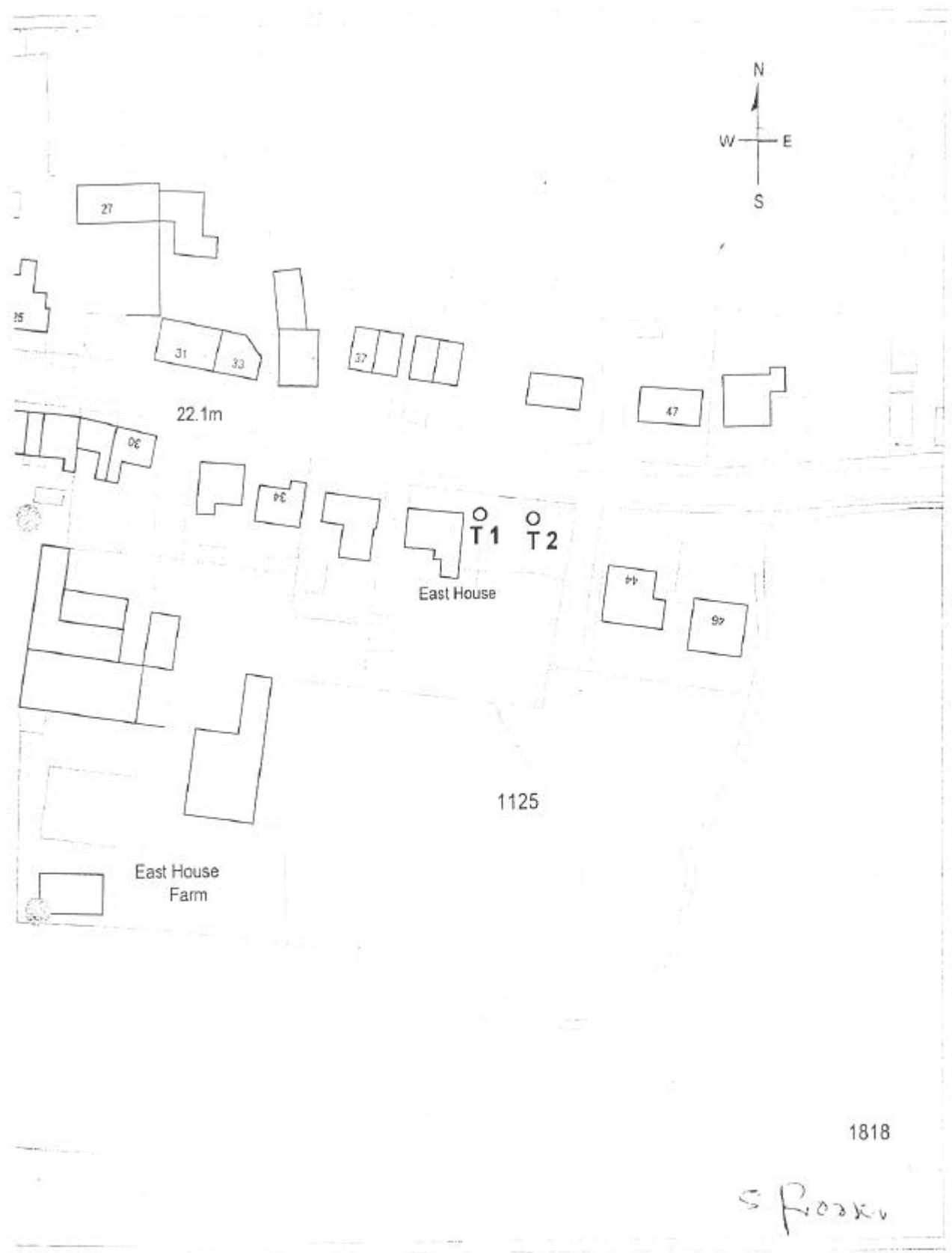

TPO No 19, 2004. EAST OF EAST HOUSE, MARSTON ROAD, TOCKWITH.



This map is based upon Ordnance Survey material with the permission of Ordnance Survey on behalf of the Controller of Her Majesty's Stationery Office. © Crown copyright. Unauthorised reproduction infringes Crown copyright and may lead to prosecution of civil proceedings. Harrogate Borough Council 100019025 2004

SCALE 1:1000  
DATE 17th Nov 2003



